

**OVERVIEW:** As a result of parking related questions raised by Birnam Wood residents at the March 9, 2023 community meeting to discuss PW778A (Phase 1 Siding & Bridge Replacement), the following is noted.

- Spring 2023 parking impacts to Lot 27R for the period April 24 - June 10 will result in the following.

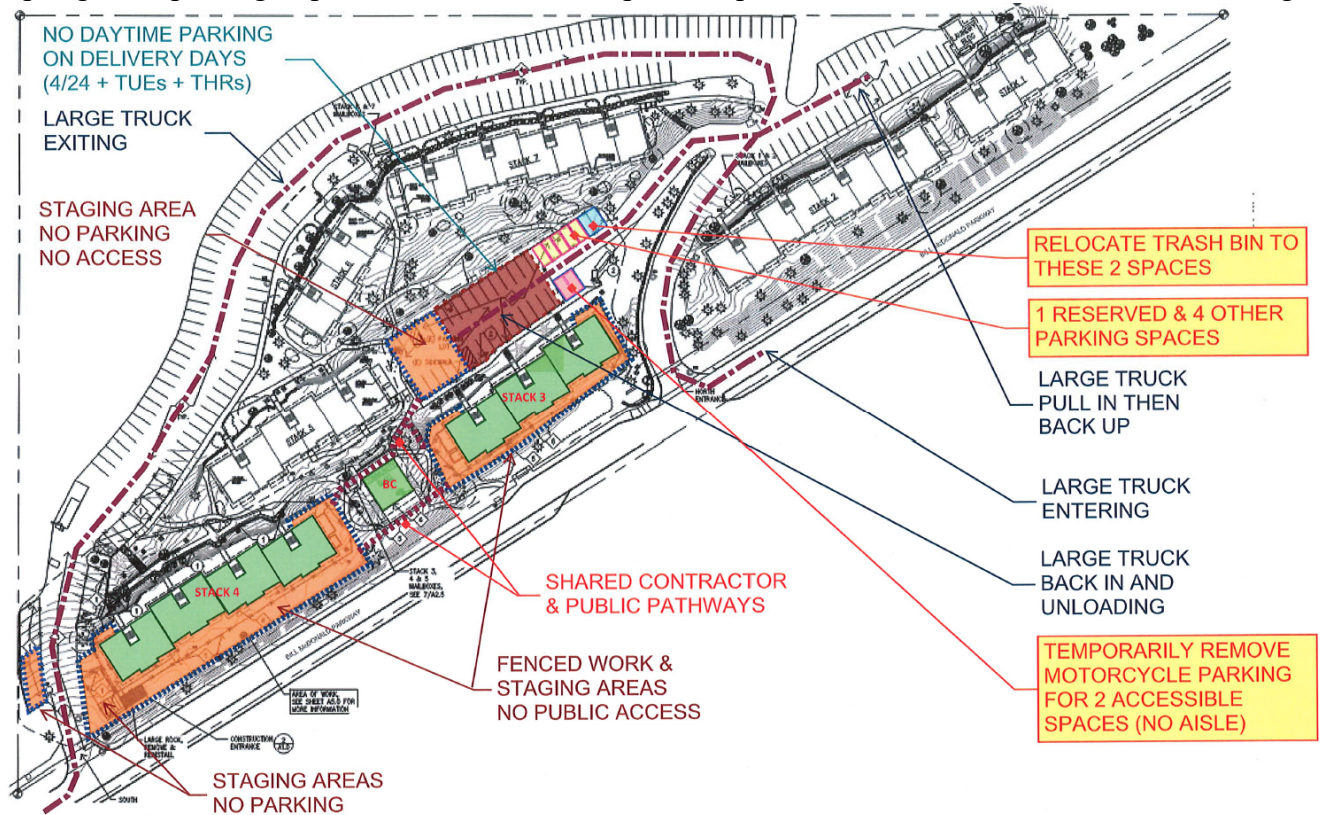

- 20 parking slots will be used as Contractor staging areas as shown above in Orange.
- During the week of April 24, parking in the central lot in front of Stack 3 (roughly 50 slots) will not be available on Monday (April 24), Tuesday (April 25), and Thursday (April 27) due to Contractor mobilization and set-up efforts.
- Moving forward, the following parking lot requirements are in play until June 12, 2023.
  - Restricted: Roughly 23 slots will have daytime parking restrictions on Tuesdays and Thursdays to support Contractor supply deliveries—no parking between 8:00am – 5:00pm.
  - Reserved: 7 slots (1 reserved for RD, 2 disabled, 4 general) will be available for unrestricted use.
- Regarding restricted usage parking slots (23) previously mentioned, residents will typically be provided a 2-week advanced notice regarding whether the Contractor will need the central lot cleared to support delivery of supplies.
  - If Lot Is Restricted Due To Planned Delivery: Birnam Wood Residents will choose one of the options on Page 2 as appropriate.
  - If Lot Is Not Designated For Delivery: Birnam Wood Residents can park in the slots for that day.

**OPTION 1 (C Lot):** If parking is not available in Lot 27R, residents can park at C Lot on a space available basis and will need to pay the \$12 daily fee as appropriate.

1. This covers parking during daytime hours (Monday – Friday, 7:00am – 4:30am).
  - Weekday nighttime hours (4:30pm – 7:00am) and weekends are free.
2. Transportation possibilities from C Lot to Birnam Wood are as follows.
  - Walking utilizing viable pedestrian routes.
  - Utilizing available Whatcom Transport Authority (WTA) bus services.
  - Utilizing WWU’s Starlight Shuttle service <https://transportation.wvu.edu/starlight-shuttle> after the WTA buses stop running for the day.
    - The shuttle runs Monday to Saturday 10:30pm – 2:30am and Sunday 9:00pm – 2:00am.
3. REIMBURSEMENT: University Residences (UR) will reimburse the \$12 per the following protocol.
  - Submit the daily parking receipt to [URFacilities@wvu.edu](mailto:URFacilities@wvu.edu). Please ensure you also provide full name, WWU ID#, room number, phone number.
  - In turn, UR will credit your student account. This may take up to two (2) weeks.

**OPTION 2 (Lincoln Creek):** If parking is not available in Lot 27R, residents can park at Lincoln Creek on a space available basis and will need to pay the \$5 daily fee as appropriate.

1. This covers parking during daytime hours (Monday – Friday, 7:00am – 4:30am).
  - Weekday nighttime hours (4:30pm – 7:00am) and weekends are free.
2. Transportation possibilities from Lincoln Creek to Birnam Wood are as follows.
  - Walking utilizing viable pedestrian routes.
  - Utilizing available Whatcom Transport Authority (WTA) bus services.
  - Utilizing WWU’s Starlight Shuttle service <https://transportation.wvu.edu/starlight-shuttle> after the WTA buses stop running for the day.
    - The shuttle runs Monday to Saturday 10:30pm – 2:30am and Sunday 9:00pm – 2:00am.
3. REIMBURSEMENT: University Residences (UR) will reimburse the \$5 per the following protocol.
  - Submit the daily parking receipt to [URFacilities@wvu.edu](mailto:URFacilities@wvu.edu). Please ensure you also provide full name, WWU ID#, room number, phone number.
  - In turn, UR will credit your student account. This may take up to two (2) weeks.

**OPTION 3 (Discretionary):** If parking is not available in Lot 27R, residents may also use their own discretion.

**PARKING LOT MAP**

